



LOMBARDINI

A KOHLER COMPANY

Group: 15LD

Engine: 15LD 225 Drawing: Z

SHORT BLOCK

POS.	CODE	DESCRIPTION	Qty
1	1560.279	conical PTO short block without equalizer device	1
1	1560.280	conical PTO short block with equalizer device	1
1	1560.281	short block EXt 3 SAE without equalizer device	1

Z
15LD

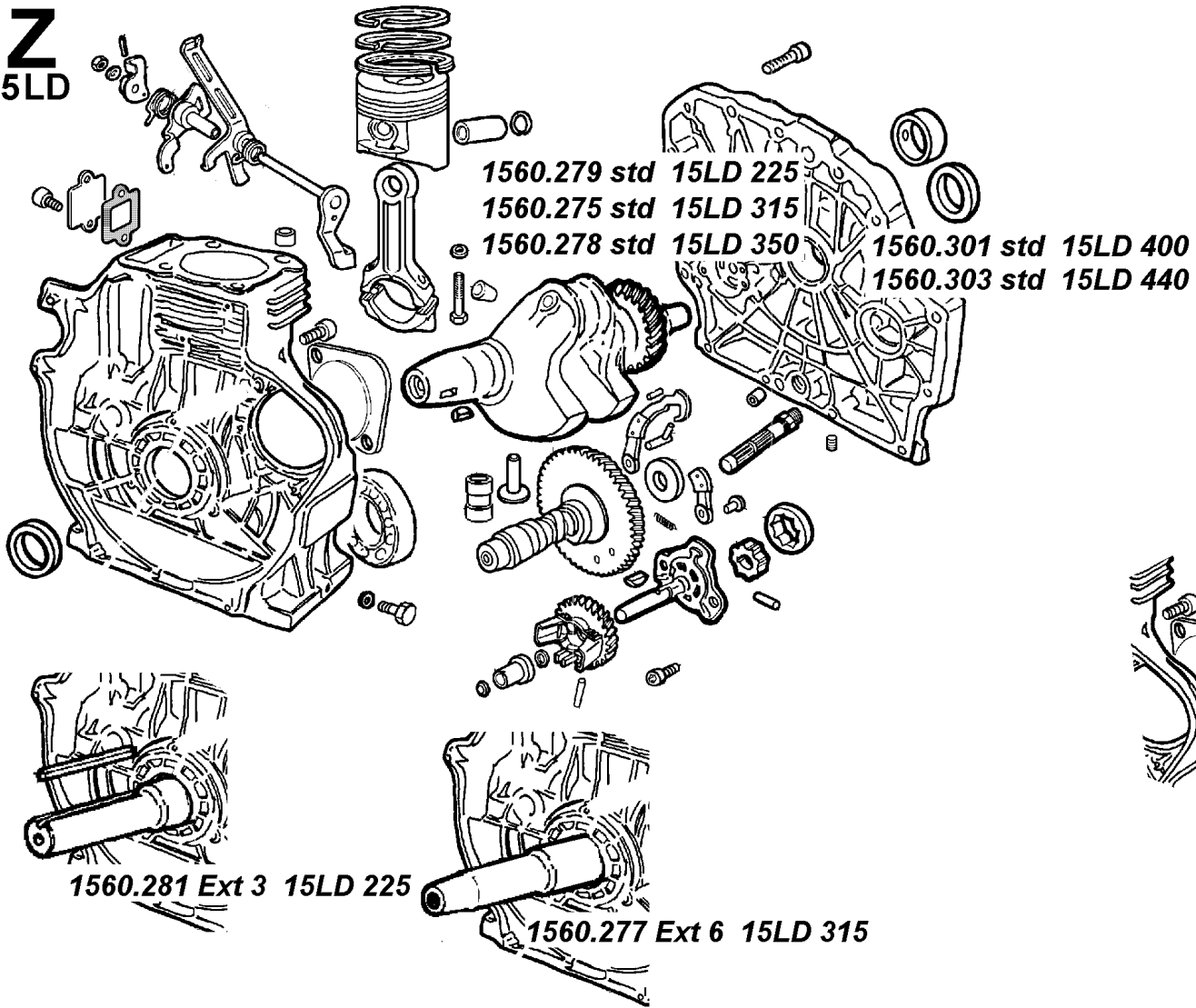

1560.280 std 15LD 225
1560.276 std 15LD 315
1560.302 std 15LD 400
1560.304 std 15LD 440
con albero equilibratore
with equalizer shaft

